

The spring band clamp has not to be in accordance with the pictorial presentation. The given values have to be met.

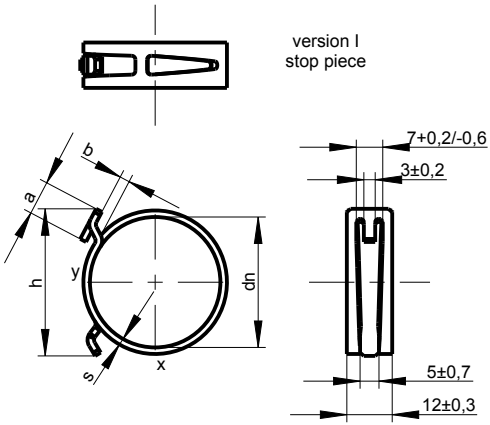

version I
stop piece

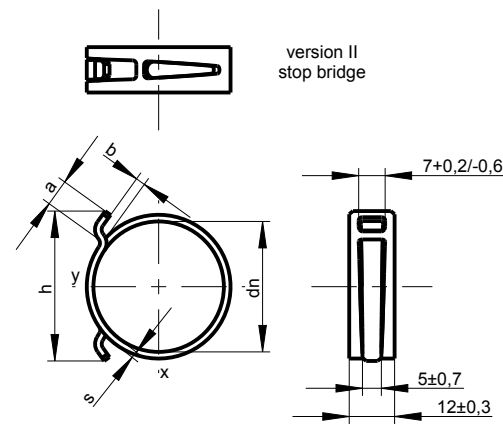

version II
stop bridge

uncontrolled
copy!

| nominal diameter dn 1) mm | version | closed diameter da 2) max mm | fully opened diameter do 3) min mm | min. functional diameter df mm | material thickness s +/- 0,4 mm | clamp load F-3-point min N | gap t 4) max mm | reference value a max mm | reference value b 5) max mm | reference value h max mm |
|---------------------------------|---------|---------------------------------------|---|--------------------------------------|--|-------------------------------------|--------------------------|-----------------------------------|--------------------------------------|-----------------------------------|
| 13,5 7) | I | 12,9 | 14,6 | 13,2 | 0,80 | 200 | 0,09 | 6,0 | | 60 |
| 14 | I | 13,3 | 15,8 | 13,7 | | 100 | | | | |
| 14,5 6) | I | 13,3 | 15,3 | 13,7 | | 200 | | | | |
| 15 | II | 13,9 | 16,5 | 14,7 | | 130 | | | | |
| 16 | I | 14,9 | 17,5 | 15,7 | | 160 | | | | |
| 17 | I | 15,6 | 18,5 | 16,3 | | 160 | | | | |
| 18 | I | 16,0 | 19,0 | 17,3 | 200 | 0,12 | 10,0 | | 92 | |
| 19 | I | 17,8 | 20,2 | 18,3 | 300 | | | | | |
| 20 | I | 18,4 | 21,6 | 19,3 | 200 | | | | | |
| 21 | I | 19,4 | 22,5 | 20,3 | 200 | | | | | |
| 22 | II | 20,5 | 24,2 | 21,3 | 200 | | | | | |
| 23 | II | 21,0 | 24,7 | 22,3 | 320 | | | | | |
| 24 | I or II | 22,0 | 26,0 | 23,3 | 230 | | | | | |
| 25 | I or II | 23,5 | 26,8 | 24,0 | 260 | | | | | |
| 26 | I or II | 24,3 | 28,0 | 25,0 | 270 | | | | | |
| 27 | II | 25,2 | 29,2 | 26,0 | 280 | | | | | |
| 28 | I | 26,1 | 30,2 | 27,0 | 300 | | | | | |
| 29 | I or II | 27,0 | 31,5 | 28,0 | 300 | | | | | |
| 30 | I | 28,0 | 32,5 | 29,0 | 300 | | | | | |
| 32 | I or II | 29,3 | 34,5 | 31,0 | 300 | | | | | |
| 34 | I | 30,6 | 36,4 | 33,0 | 300 | | | | | |
| 35 | I or II | 31,5 | 38,0 | 34,0 | 300 | | | | | |
| 36 | I | 32,5 | 39,0 | 35,0 | 300 | | | | | |
| 38 | II | 34,5 | 41,5 | 37,0 | 300 | | | | | |
| 40 | II | 35,5 | 42,5 | 39,0 | 300 | | | | | |
| 41 | II | 36,3 | 43,5 | 40,0 | 370 | | | | | |
| 42 | II | 37,2 | 44,5 | 40,5 | 420 | | | | | |
| 43 | II | 37,9 | 45,9 | 41,5 | 340 | | | | | |
| 44 | I | 38,5 | 46,5 | 42,5 | 340 | | | | | |
| 46 | II | 40,5 | 48,5 | 44,5 | 350 | | | | | |
| 47 | I or II | 41,4 | 50,0 | 45,5 | 380 | | | | | |
| 48 | II | 41,9 | 51,0 | 46,5 | 410 | | | | | |
| 49 | I or II | 42,5 | 52,0 | 47,5 | 410 | | | | | |
| 50 | II | 43,5 | 53,0 | 48,5 | 410 | | | | | |
| 51 | I or II | 44,0 | 54,0 | 49,5 | 410 | | | | | |
| 53 | I | 46,0 | 55,8 | 51,5 | 410 | | | | | |
| 55 | I | 46,8 | 58,0 | 53,5 | 430 | | | | | |
| 58 | I | 50,0 | 61,5 | 56,5 | 450 | | | | | |
| 70 | II | 61,5 | 74,8 | 68,5 | 2,50 | 370 | 0,15 | | | |

- The spring band clamps have to be opened to the full opened diameter and released prior to inspection tests.
- Only by Muhr und Bender recommended tools have to be used to assemble the spring band clamps.
- Technical delivery conditions MUBEA HC 88 - MUB-Norm A-FBS-001
- Manufacturer mark "MU" has to be provided at suitable place.
- Clamp material 51CrV4 with:
C = 0,50 - 0,55%, Si = 0,15 - 0,35%, Mn = 0,80 - 1,10%,
Cr = 0,90 - 1,20%, V = 0,10 - 0,20%, P < 0,025%, S < 0,015%.
- Clamp corrosion protection:
Multilayer, chrome (VI)-free coating made of an organic or inorganic base coat containing zinc and an organic top coat.
Color: grey, optional black

- Nominal diameter is not equivalent to the diameter as shipped
- Measured on dimensional level x
- Determined by means of measure mandrel
- Roundness deviation is determined according to MUBEA HC 88 - MUB-Norm A-FBS-001
- Determined at nominal diameter
- Check requirements acc. to HC 88 dn14
- Leakage test acc. to HC 88 dn 13

| | | | |
|---------------------------|----------|----------------------------|--|
| CAD-System: Pro/E WF 2 | | Maßstab | |
| Werkstoff | | see Text | |
| Datum | | Name | |
| Bearb. | 17.01.12 | Berghoff | |
| Gepr. | 17.01.12 | Lovato | |
| Norm | | | |
| aa Tol. 5 +/-0,7 | | 07.05.12 db | |
| z System Pro/E | | 17.04.12 db | |
| y 3-P-F 42 | | 16.04.12 db | |
| Zust. | | Änderung Datum Name Urspr. | |
| MUHR & BENDER KG | | 57439 ATTENDORN | |
| Zeichnungs Nr. | | Blatt | |
| 6200100124-03 | | B. | |
| Ers. f. | | Ers. d. | |